

HYDRAULIC CLAMPING SYSTEM

CSP-HYDRAULIC SUPPORT CLAMP

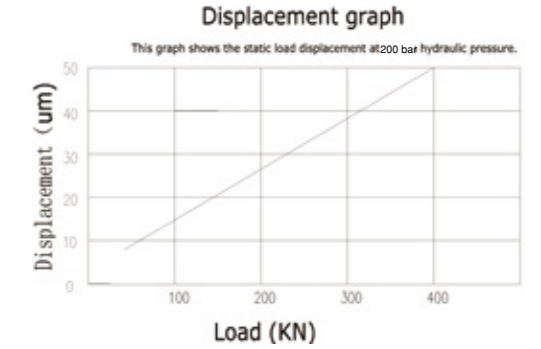
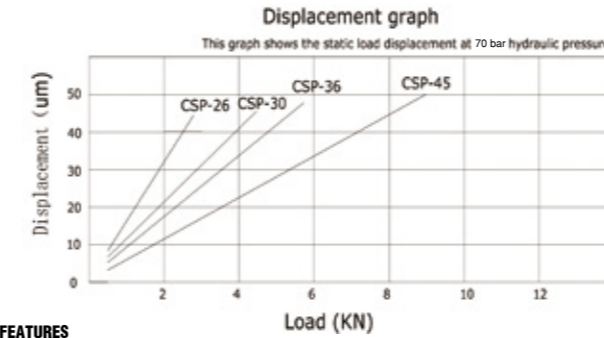
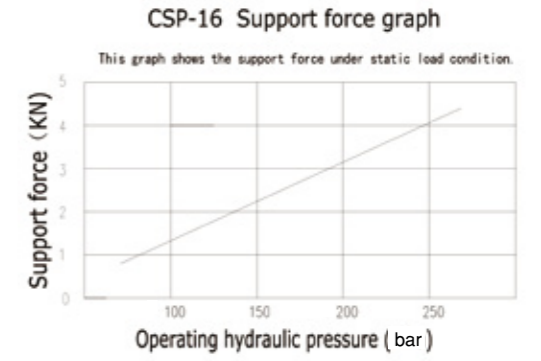
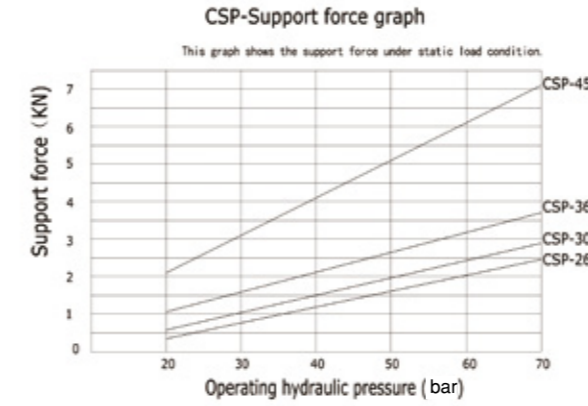
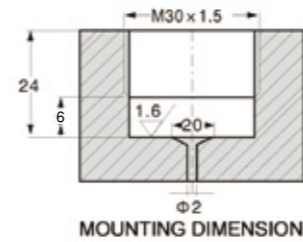
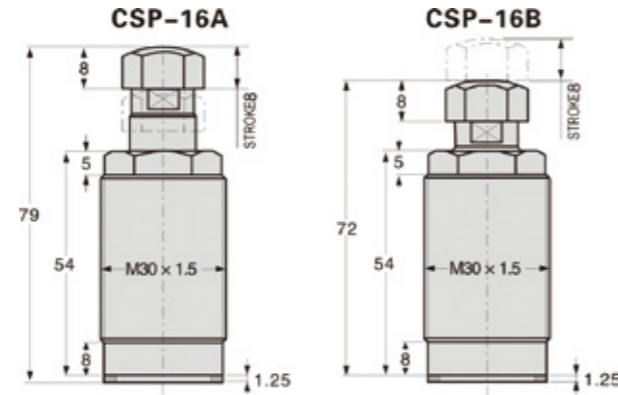
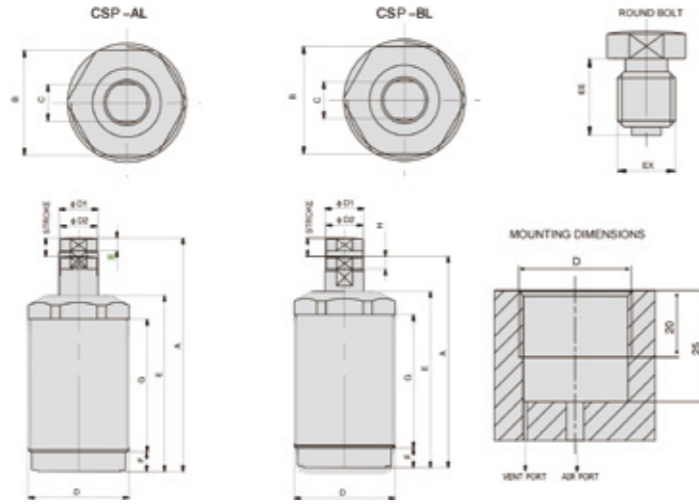

FEATURES

The working pressure of supporting cylinder is from 20 to 70 bar, with clamp cover and double acting piston, taking the low pressure on the oil to gain high supporting pressure.
 The contact strength between piston rod and the work pieces is small (0.3-0.87 bar), and it can be applied on the various types of work pieces.
 The size is small (four kinds, M26-M45. Large caliber, high supporting strength, can work steadily within the low pressure.) No need to change the size of fixture plate, and can be installed in small space.

NOTE

Columns fortress cannot exert eccentric load.
 Can't exert overloaded.
 Can't turn the piston rod when it's locking state.

Type A: Supporting with the spring, the spring is used to control a clamping force when the piston rod extends to a highest support position, then clamps the work piece and lock the piston in a supporting condition .

Type B: Supporting with oil pressure, it is operated by means of oil pressure and is keeping in a supporting condition when being filled with oil and clamp the work piece.

LOW PRESSURE

Max: operating pressure 70 bar
 Min: operating pressure 20 bar

HIGH PRESSURE

Max: operating pressure 250 bar
 Min: operating pressure 100 bar

Single acting

ORDERING INDICATION

CSP - 26AL - C-L

CSP	Series	CSP
26	Hydraulic cylinder inside diameter	φ26,φ30,φ36,φ45
AL	Type	Low pressure AL: type A BL: type B High pressure A: type A B: type B
C	version	
L	Plunger spring force	L: low spring H: high spring

Low pressure

MODEL	CLAMPING FORCE AT 70 bar (KN)	CLAMPING FORCE AT 20 BAR (KN)	STROKE(mm)	OLL CAPACITY(cm³)	PISTON AREA(cm²)
CSP-26AL	2.30	0.39	5.5	0.30	0.79
CSP-26BL	2.30	0.39	5.5	0.30	0.79
CSP-30AL	2.70	0.6	8	0.50	1.13
CSP-30BL	2.70	0.6	8	0.50	1.13
CSP-36AL	3.70	1.2	8	0.60	1.54
CSP-36BL	3.70	1.2	8	0.60	1.54
CSP-45AL	6.80	2.1	10	1.30	2.01
CSP-45BL	6.80	2.1	10	1.30	2.01

High pressure

MODEL	CLAMPING FORCE AT 250 bar (KN)	CLAMPING FORCE AT 100 BAR (KN)	STROKE(mm)	OLL CAPACITY(cm³)	PISTON AREA(cm²)
CSP-16A	4.10	1.4	8	0.60	2.01
CSP-16B	4.10	1.4	8	0.60	2.01

MODEL	A	B	C	D	E	F	G	H	D1	D2	EE	EX
CSP-26AL	71.5	22	9	M26*1.5	57	6	44	3.6	φ10	φ9.8	10	M8
CSP-26BL	66	22	9	M26*1.5	57	6	44	3.6	φ10	φ9.8	10	M8
CSP-30AL	81	24	10	M30 1.5	62	6	48	5.1	φ12	φ11.5	10.9	M8
CSP-30BL	73	24	10	M30*1.5	62	6	48	5.1	φ12	φ11.5	10.9	M8
CSP-36AL	77	30	12	M36*1.5	58	6	44	4.7	φ14	φ13.5	10.3	M10
CSP-36BL	69	30	12	M36*1.5	58	6	44	4.7	φ14	φ13.5	10.3	M10
CSP-45AL	92	36	14	M45*1.5	71	7	54.8	4.6	φ16	φ15.5	13.4	M10
CSP-45BL	82	36	14	M45*1.5	71	7	54.8	4.6	φ16	φ15.5	13.4	M10

Unit:mm